

A large crowd of people is gathered in a nightclub, illuminated by blue and white laser lights. A large disco ball hangs from the ceiling, reflecting the light. The background shows a stage area with a DJ booth and various equipment.

# W — WALTER — HERE?HOUSE

702 North 21st Avenue  
Phoenix, Arizona 85009

# WELCOME TO WALTER WHERE?HOUSE!

Step into creativity and expression at Walter Where?House! Once a 1940s paper factory, this unique venue has been transformed into a modern-day immersive haven. Every corner of the space is brimming with character, thanks to the passion and vision of local artists who've infused the venue with details that spark childlike wonder.

Whether you're dreaming of art cars, unforgettable productions, or a touch of magic, our team is here to help you bring your vision to life. At Walter Where?House, the possibilities are endless—let your imagination run wild!

# VENUE HIGHLIGHTS

---

1,650 Standing Capacity

World Class Audio Visual

Abundant Art & Unique Art Cars

Centrally Located

Accessible by Major Freeways

10 Mins from Sky Harbor Airport

Superior Amenities

Incomparable Guest Experience

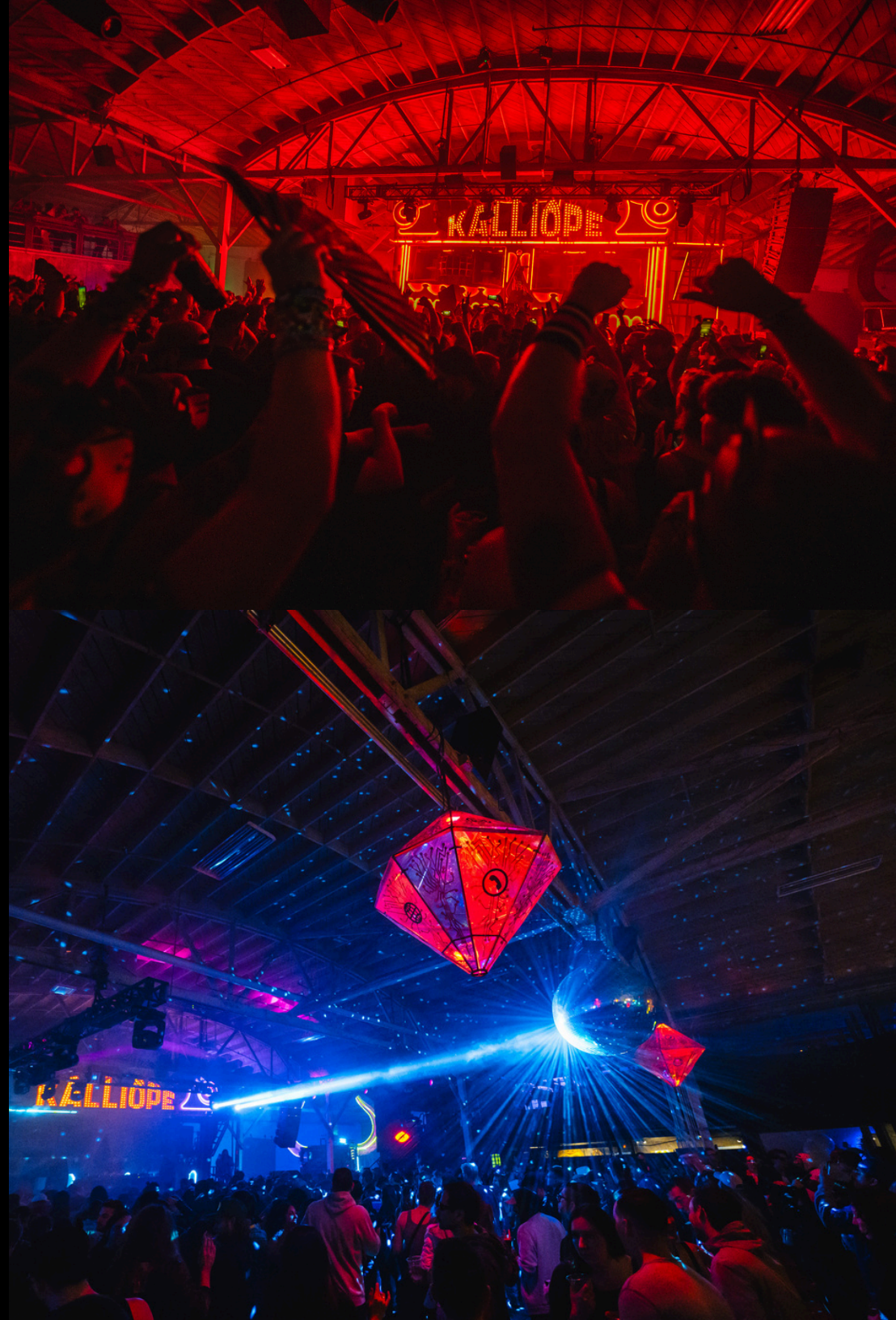

# ARTIST AMENITIES

---

**Private Comfortable Green Room**

**Refridgerator/Freezer**

**Private Shower & Restroom**

**Climate Controlled**

**Overflow Green Room for Support**

**Private Access to Hospitality**

**Main PA Sound Feed into Green Room**

**WIFI**





**ARTIST DRESSING ROOM**



**LOCAL ART GALLERY**



**KALLIOPE STAGE**



**GREEN ROOM**

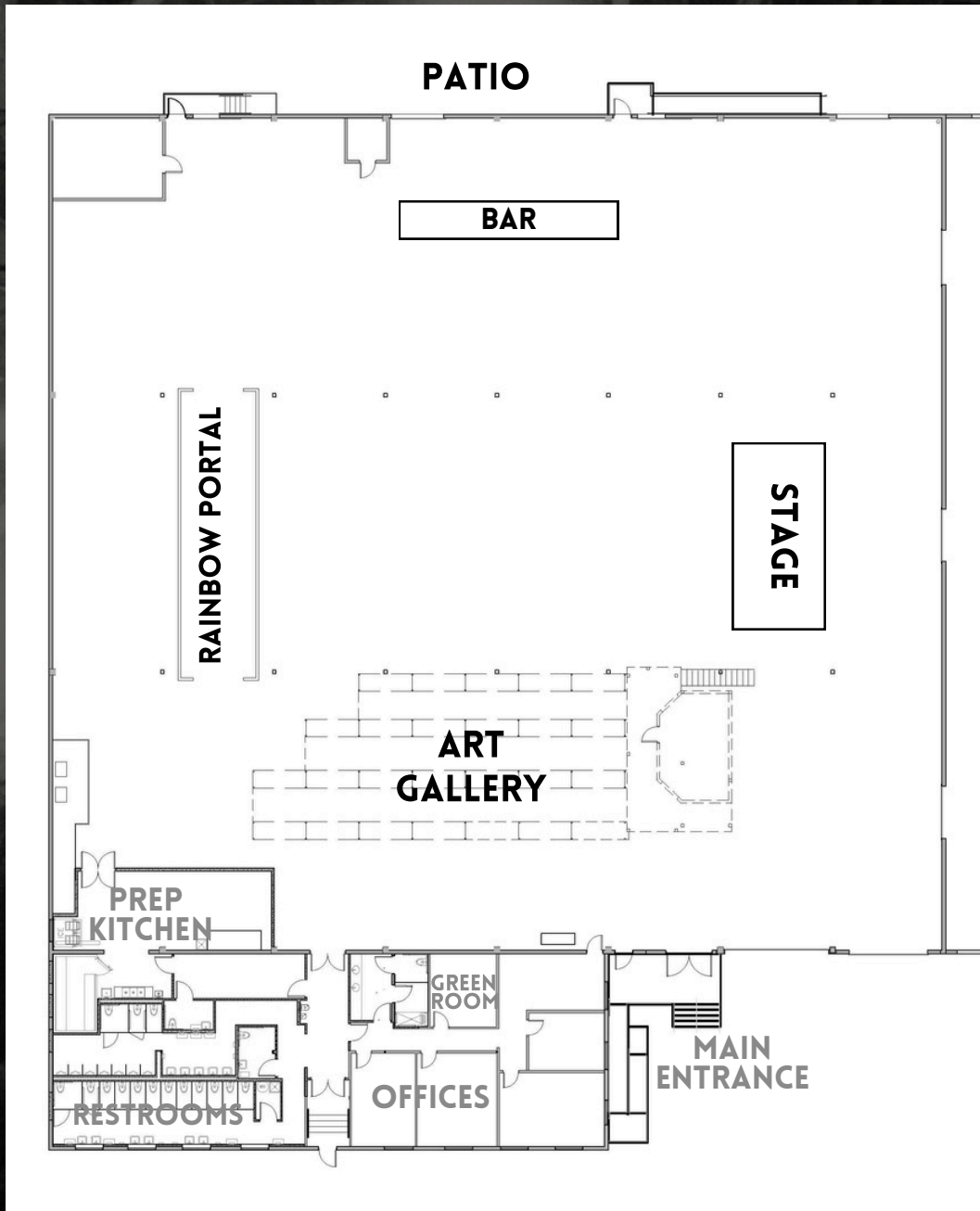

# VENUE LAYOUT

# TECH SPECS

---

## AUDIO

FOH Speaker System :

Meyer Sound Leopard Line Array

Meyer Sound 900 series single 18" powered (L/R)

Meyer Sound 1100 series dual 18" powered (Centered)

Meyer X-40 Series Center Fill (Flown)

Meyer X-40 Series Delay Fills (L/R)

QSC Distributed House Fills For Full Coverage

Meyer Galaxy System Processor

(AES or Analog input)

FOH Console: Midas M32 with DL32 Stagebox

Monitor Console: Monitors from FOH

(Seperate monitor console optional)

## MONITOR OPTIONS

Meyer Sound 15" Powered Monitors

Meyer Sound Dual 18" Powered Subs

## DJ BACKLINE

Pioneer DJM-900NXS2

Pioneer DJM A9

Pioneer DJM-V10

Pioneer CDJ 3000



# TECH SPECS

---

## LIGHTING/EFFECTS

- (2) Varilite 3000 Spot
- (8) Elation Platinum Beam 5R
- (4) Clay Paky Sharpy
- (48) Chauvet SlimPar Pro RGBAUV
- (12) Elation Six Par 100
- (4) Martin Atomic Strobes
- (2) Elation 3K Strobes
- (4) Elation Protron Color 3K Strobes
- (3) Ultratec Radiance Hazer

Optional: RGB Lasers, Bubbles, Confetti

All Art Cars Console-Controlled RGB DMX

Control: Chamsys MagicQ

## POWER

200A 3-Phase 208V Camloc Disconnect,  
Upstage Left

(4) 50A 208v CS-Style at various locations



# GUEST EXPERIENCE

---

Curated Local Art Gallery

Merch Sales Display

Coat Check

Art Cars

Rainbow Portal

Fresh Air Patio

Fast Bar & Food Service

Walter Ambassadors

Exceptional Walter Vibe





**THEY  
LOVE  
US!**



Click here to view our  
reviews on **Google!**





**PLAY HERE**

